

## DPH/GPH/EPH/LPH Parts Lists Top Assembly

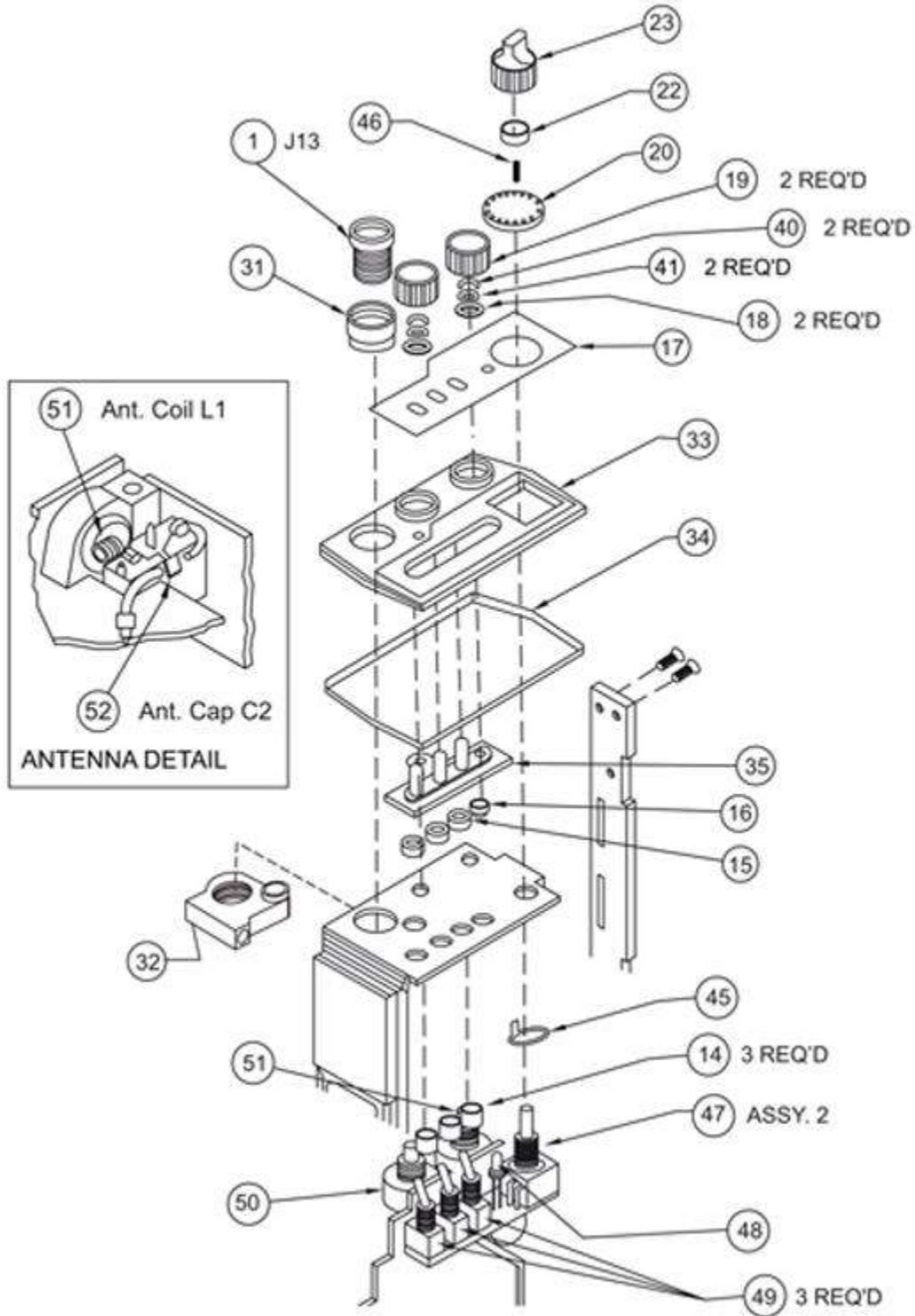

**Vincent Communications Inc – (559-292-7010) – www.vincentcom.com**

<b>Ref #</b>	<b>Part #</b>	<b>Description</b>
1	2114-40007-600	Conn, Adptr, RF (J13)
14	2800-20027-400	Spacer, Switch
15	2856-20003-301	Nut, Spanner, (0.250 X 0.065)
16	1411-40005-600	Bushing, LED, Molded, EP
17	2509-50704-901	TA - SCN - PRI
17	2509-50704-912	Inlay,Top,EPH5141,
17	2509-50704-934	A - B - C
17	2509-50704-908	A/B - SCN - PRI
18	2856-20003-302	Nut, Spanner (0.300x0.075)
19	2402-40004-701	Knob, Vol/Sq
20	1405-30093-201	Chan, Bezel. Sw, Molded, (CMD)
20	1411-40006-001	Chan, Bezel. Sw, Molded, 14 CH
20	1405-30093-200	Chan, Bezel. Sw, Molded, 16 CH
23	2402-50241-001	???
23	2402-50541-602	Knob,Assy.,Channel- ???
31	1411-40005-400	Antenna, Bushing, Molded, EP
32	1411-40005-700	Antenna, Nut, Molded, EP
33	1411-50701-404	Plate, Top, Blk, GPH
34	2512-20034-200	O Ring, 1.693 X .039
35	1411-40004-200	Boot, Sw,Molded, EP, Pos xxxo
40	2847-20035-001	Washer, Curved, Spring
41	2840-30191-936	Washer, .140x.281, Ss
45	2840-20028-600	Washer,Channel-Sel,
46	7019-40528-500	Pin,Dow,.047DX.165L with addendum
47	5111-30942-501	Switch, Rotary no-stop (CMD)
47		Switch, Rotary 14pos (E-Series)
47	5111-30942-500	Switch, Rotary 16 pos (DPH, GPH)
48	4810-20009-302	Di,LED,Yel.
49	5114-20004-300	Toggle Switches
50	4750-20003-904	Squelch Res,Var,100K_Ohm (R85)
51	4750-20003-903	On/Off Res,Var,10K_Ohm (R51)
51	1801-20061-006	AW Coil, (L1 DPH/GPH)
51		Coil,(L1 EPU/EPV)
52		(C2 EPU/EPV)
52	1524-20065-501	Cap, 4.7 PF, 100V (C2 DPH/GPH)

**Vincent Communications Inc – (559-292-7010) – [www.vincentcom.com](http://www.vincentcom.com)**